

NEPPSC

NORTHEASTERN PLANT, PEST AND SOILS CONFERENCE



Condensed Program

THE NORTHEASTERN PLANT, PEST, AND SOILS CONFERENCE

2018

A joint meeting of:



Philadelphia, PA; January 9-11, 2018

Hilton Philadelphia Penn's Landing

Participating Societies:

Northeastern Weed Science Society (Host Society)

Northeastern Regional Branch of American Society of Agronomy, Crop Science Society of America, & Soil Science Society of America

American Society of Horticultural Science - Northeast Division

Sustaining Members

The societies comprising the NEPPSC would like to thank the individuals and organizations that help sustain our operations.

Sustaining Members for each society are displayed at the registration desk.

If you would like more information about a sustaining member, click on any of the logos on the "Sponsors" page at:

<http://www.neppsc.org>

Meeting Location

Hilton Philadelphia Penn's Landing
201 S. Christopher Columbus Blvd
Philadelphia, PA 19106
(215) 521-6500

<http://www3.hilton.com/en/hotels/pennsylvania/hilton-philadelphia-at-penns-landing-PHLPNHH/index.html>

Directions and Transportation

From I-95: Take I-95 to Exit 20 (Washington Avenue/Columbus Boulevard). Make a left onto Columbus Boulevard. Hotel is one mile north on the right.

From the Ben Franklin Bridge: Once over the bridge in Philadelphia, travel on the ramp towards I-95. Take I-95 South to Exit 20 (Washington Avenue/Columbus Boulevard). Make a left onto Columbus Boulevard. Hotel is one mile north on the right.

From the Walt Whitman Bridge: Once over the bridge in Philadelphia, bear to the right towards I-95. Take I-95 North to Exit 20 (Washington Avenue/Columbus Boulevard). Make a left onto Columbus Boulevard. Hotel is one mile north on the right.

From the Philadelphia Suburbs: Take I-76 East to I-676 East. Continue on I-676 East to I-95 South. Take I-95 South to Exit 20 (Washington Avenue/Columbus Boulevard). Make a left onto Columbus Boulevard. Hotel is one mile north on the right.

Hilton at Penn's Landing

Floor Plan

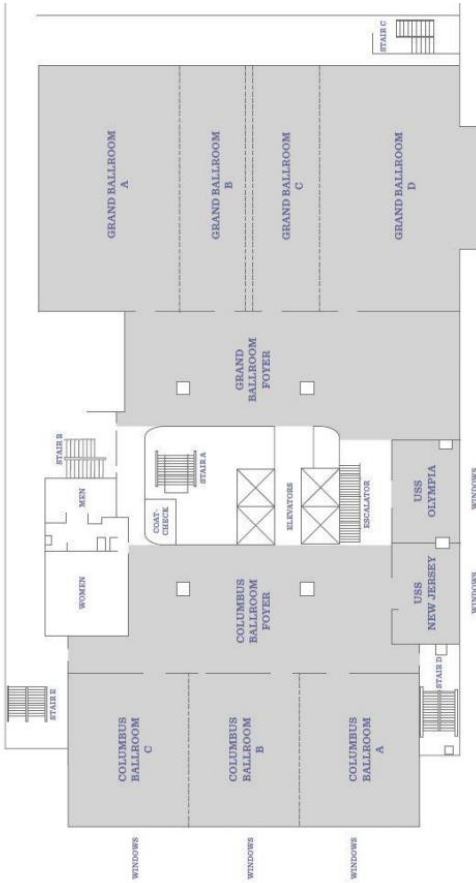

SOCIETY PRESIDENTS

Randy Prostak, NEWSS President

rprostak@umass.edu

Karen Gartley, NE-ASA/CSSA/SSSA President

kgartley@udel.edu

Tim Elkner, NE-ASHS President

tee2@psu.edu

NEPPSC PROGRAM COMMITTEE

Carroll Moseley, Program Chair & NEWSS Rep.

carroll.moseley@syngenta.com

Karen Gartley, NE-ASA/CSSA/SSSA Rep.

kgartley@udel.edu

Tim Elkner, NE-ASHS Program Rep.

tee2@psu.edu

CONDENSED PROGRAM

MONDAY, JANUARY 8, 2018

Early a.m. – 2:45 p.m.

Board Travel NEPPSC

3:00 p.m. – 4:30 p.m.

NEWSS Board Meeting
(New Jersey)

4:30 p.m. – 5:00 p.m.

NEPPSC Program
Committee Meeting (New
Jersey)

5:00 p.m. - 5:30 p.m.

NEPPSC Program
Committee & Session
Chairs Meeting (New
Jersey)

TUESDAY, JANUARY 9, 2018

Early a.m. – 10:00 a.m.	Travel Time
10:00 a.m. – 12:00 p.m.	Potential Committee Meetings Including Awards, Nominations, Weed Contest, and Endowment (and possibly others – to be updated)
10:30 a.m. - 4:00 p.m.	Registration (Ballroom Foyer)
1:00 p.m. - 3:00 p.m.	Industry and Extension Roundtable Discussions Agronomic Crops & Soils (Columbus A) Fruit, Veg., and Tree Crops (Columbus B) Turf & Ornamental (Columbus C)
3:00 p.m. – 3:15 p.m.	Break
3:15 p.m. - 5:15 p.m.	NEPPSC Opening Ceremony (Ballroom AB)
3:15 p.m. Welcome	Randy Prostak, NEWSS; Karen Gartley, NE-Tri-Societies; Tim Elkner, NEASHS
3:45 p.m. – 4:30 p.m.	Good, Difficult, Different – Planning for Future Years
4:30 p.m. – 5:00 p.m.	Welcome to PA-Featured Speaker Deputy Secretary Fred Strathmeyer, Jr., PA Dept of AG
5:00 p.m. – 5:15 pm	Close Out Opening Ceremony
5:30 p.m. - 7:30 p.m.	NEPPSC Social Mixer & Grad Student Quiz Bowl (Ballroom CD)

- | | |
|------------------------|---------------------------------------|
| 8:00 p.m. - 10:00 p.m. | Poster Setup (Columbus A) |
| 8:00 p.m. - 10:00 p.m. | Commercial Display Setup (Columbus A) |

WEDNESDAY, JANUARY 10, 2018

- | | |
|-------------------------|--|
| 7:00 a.m. - 8:35 a.m. | NEPPSC Posters – authors present (including student posters) (Columbus A) (authors present) |
| 7:30 a.m. – 4:00 p.m. | Registration (Ballroom Foyer) |
| 8:45 a.m. - 11:45 p.m. | Student Oral Presentations: (Columbus B) |
| 10:00 a.m. – 10:15 a.m. | Break |
| 11:50 a.m. – 12:50 p.m. | Grad Student Luncheon (Admiral's Quarters) |
| 1:00 p.m. – 5:00 p.m. | Symposium: Integrating New Technology to Meet the Future Challenges of Agriculture: A Sharing of Experiences (Ballroom CD) |
| 5:15 p.m. 6:30 p.m. | NEWSS Awards (Columbus B) |
| 5:15 p.m. - 6:30 p.m. | NE-ASHA business meeting (Columbus C) |
| 9:00 p.m. - 11:00 p.m. | Industry Dessert Social and Survival Skills Interaction (Ballroom CD) |

THURSDAY, JANUARY 11, 2018

- | | |
|-----------------------|---|
| 7:00 a.m. - 8:30 a.m. | NEWSS Past Presidents' Breakfast (Admiral's Quarters) |
| 7:30 a.m. - 3:00 p.m. | Registration (Ballroom Foyer) |

8:45 a.m. - 10:00 a.m.	Student Oral Presentations: (Columbus B)
10:00 a.m. – 10:15 a.m.	Break
9:45 a.m. – 4:15 p.m.	Fruit, Veg., & Tree Crops (Columbus C)
10:15 a.m. – 4:00 p.m.	Turf and Ornamentals (Grand Ballroom CD)
10:15 a.m. – 2:00 p.m.	Agronomic Crops (Columbus B)
2:00 p.m. – 3:00 p.m.	Veg Mgt (Columbus B)
4:30 p.m. – 6:15 p.m.	NEWSS business meeting (Columbus B)
4:30 p.m. – 6:15 p.m.	NE-ASA/CSSA/SSSA business meeting (Ballroom CD)
3:15 p.m. – 6:30 p.m.	Poster & Commercial Display Removal (Columbus A)

FRIDAY, JANUARY 12, 2018

8:30 a.m. – 9:00 a.m.	NEPPSC Organizing Committee (New Jersey)
9:00 a.m. – 11:00 a.m.	NEWSS Board Meeting (New Jersey)

!! IMPORTANT !!

**Deadline for Uploading
Presentations**

Sunday, January 7, 2018

All presentations* must be uploaded to

<http://www.wssaabstracts.com>

**Questions regarding presentation
upload or special formatting, should be
directed to the respective moderator.**

***Note to students: A 10-point penalty
(minimum) will be assessed in contest
scoring for late submissions.**